

# Stainless Body, Vertical Shaft, Multi-Stage Centrifugal Pump

## OUTSTANDING PUMP FEATURES

- ✓ Pump housing is made of AISI 304 stainless steel.
- ✓ Resistance up to 100 g / m<sup>3</sup> for max. 0.2 mm particle in water.
- ✓ Ability to operate in the temperature range of +4 °C to +60 °C.
- ✓ Safe use in the pH range of 6.5 to 8.5.

## APPLICATION AREAS

- ✓ Safe use in booster pump systems.
- ✓ For garden and greenhouse irrigation systems.
- ✓ For domestic and commercial applications.
- ✓ For boiler water supply.
- ✓ For fire extinguishing systems.

## EFFICIENT & DURABLE

- ✓ In the flow rate range of 0.5 to 6 m<sup>3</sup>/h.
- ✓ Pump head of 20 to 77 mSS range.
- ✓ High efficiency, silent, stable operation.

## OUTSTANDING MOTOR FEATURES

- ✓ 230V / 380V supply voltage, 50 Hz.
- ✓ Motor power: 1.5 - 3 HP
- ✓ Asynchronous, with 2 poles.
- ✓ IP 44 protection, F-insulation grade.
- ✓ Available for continuous operation.
- ✓ Air cooled type.

### PL / PLD SERIES PARTS and MATERIAL TABLE

Part Name	Material
Pump Housing	AISI 304 SS
Diffuser	PPO
Fan	Noryl
Motor Casing	Aluminum
Mechanical Seal	Graphite / Ceramic
Pump Shaft	AISI 304 SS ASTM 5140

**NEW** Diamond PL / PLD



Pioneer in the pump,  
with the assurance of Alarko Carrier...

# Stainless Body, Vertical Shaft, Multi-Stage DIAMOND PL / PLD CENTRIFUGAL PUMP

It is ideal for sprinkler and irrigation operations in gardens, touristic facilities...

## Pump Flow (Q) - Pressure (H) Table

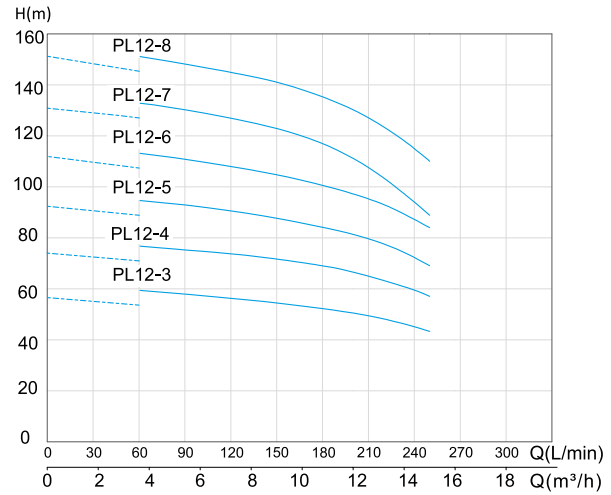
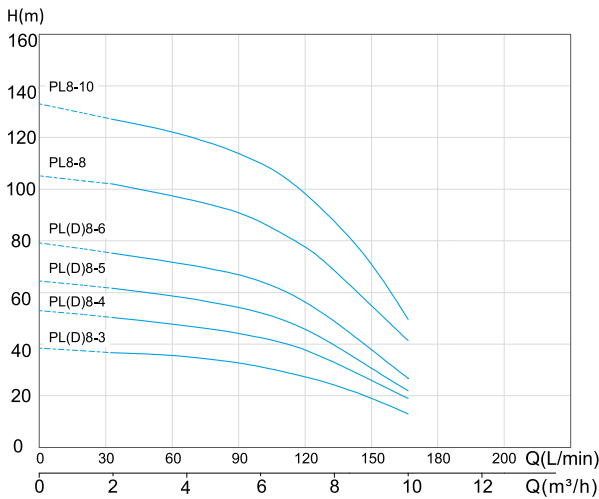
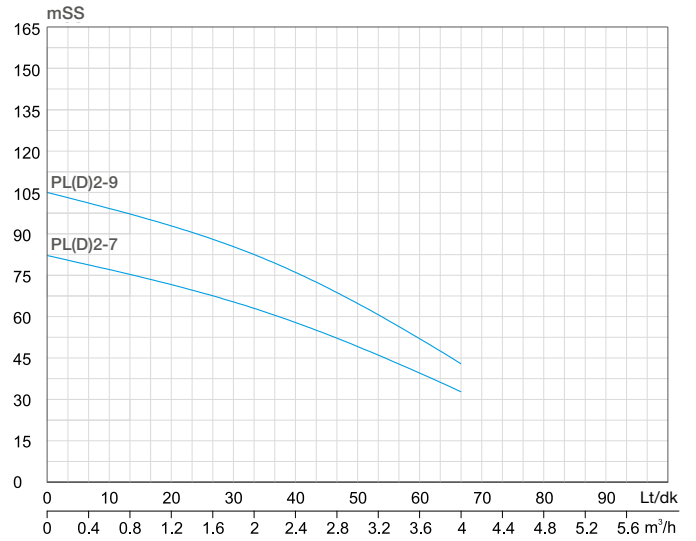
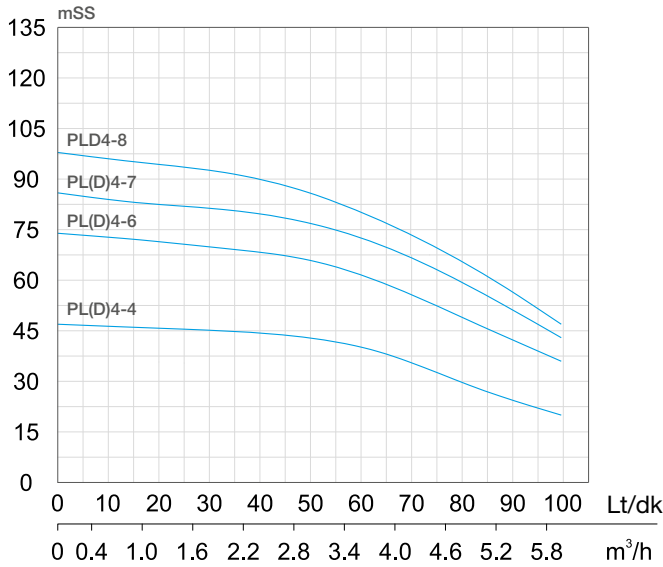

### PERFORMANCE and SIZE CHART

Model	Q Max. (m³/h)	Q Ort (m³/h)	H (m)	Power		Voltage (V)	Current (A)	Connection Diameter (Dh)	Model		DN1	DN2	H	H1	H2	A	B	C	D	E	L
				Power	Power				220V	380V											
PLD2-7	4	2	65,5	1,1	1,5	220V	7	25	PLD2-7	380V	G1	G1	43,5	248,5	560,5	140	140	185	130,5	221	139,5
PLD2-9			84	1,5	2		9,5		PLD2-9	G1	G1	43,5	296,5	608,5	140	140	185	130,5	221	139,5	
PLD4-4	6	4	39	1,1	1,5		7		PLD4-4	G1	G1	43,5	176,5	487	140	140	185	130,5	221	139,5	
PLD4-6			58	1,5	2		9,4		PLD4-6	G1	G1	43,5	224,5	535	140	140	185	130,5	221	139,5	
PLD4-7			69	1,8	2,4		11,3		PLD4-7	G1	G1	43,5	248,5	559	140	140	185	130,5	221	139,5	
PL4-6			58	1,5	2		9,4		PL4-6	G1	G1	43,5	224,5	535	140	140	185	130,5	221	139,5	
PL4-8			77	2,2	3		4,8		PL4-8	G1	G1	43,5	272,5	583	140	140	185	130,5	221	139,5	
PL8-6			46	2,2	3		4,8		PL8-6	G1 1/4	G1 1/2	43,5	239,0	550	140	140	193	111,5	201	119,0	
PL8-8	10	8	62	3	4		6,2		PL8-8	G1 1/4	G1 1/2	43,5	292,0	676	140	140	209	112,0	234	137,0	
PL8-10			78	4	5,5		8,1		PL8-10	G1 1/4	G1 1/2	43,5	345,0	729	140	140	209	112,0	234	137,0	
PL12-3	15	12	42	3	4	6,2	PL12-3	G1 1/4	G1 1/2	43,5	187,5	570	164	164	195	119,0	234	137,0			
PL12-4			57	4	5,5	8,1	PL12-4	G1 1/4	G1 1/2	43,5	219,5	602	164	164	195	119,0	234	137,0			
PL12-6			88	5,5	7,5	10,9	PL12-6	G1 1/4	G1 1/2	43,5	283,5	675	164	164	233	124,0	266	157,0			
PL12-7			104	7,5	10	14,5	PL12-7	G1 1/4	G1 1/2	43,5	315,5	745	164	164	269	137,0	302	175,0			
PL12-8			120	7,5	10	14,5	PL12-8	G1 1/4	G1 1/2	43,5	347,5	777	164	164	269	137,0	302	175,0			

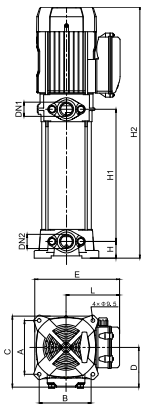

Note: Manufacturer reserves the right to change any product specifications without notice.



ALARKO CARRIER  
SANAYİ VE TİCARET A.Ş.

GOSB - Gebze Organize Sanayi Bölgesi, Şahabettin Bilgişu Cad.

No:1604 Gebze 41480 KOCAELİ - TÜRKİYE

Phone: +90 262 648 60 00

Fax: +90262 648 60 08

[www.alarko-carrier.com.tr](http://www.alarko-carrier.com.tr)

[info@alarko-carrier.com.tr](mailto:info@alarko-carrier.com.tr)