

Monoblock for Domestic use Centrifugal Pump

PRACTICAL, RELIABLE

- ✓ Special control box for easy cable connection.
- ✓ So Light: weight 12 ~ 19 kg.
- ✓ Compact: length 31.1 ~ 36.9 cm.
- ✓ Available ports for additional controllers.

APPLICATIONS

- ✓ Suction lift up to 7 mt. from open wells and tanks.
- ✓ Garden and greenhouse irrigation.
- ✓ Domestic and commercial applications.

EFFICIENT AND STURDY

- ✓ 2 different types in flow rate of 0.6 - 30 m³/h.
- ✓ Pump head range of 8 - 36 mWC.
- ✓ Graphite / Ceramic mechanical seal.

SUPERIOR PUMP FEATURES

- ✓ Pump Body: cast iron,
Motor casing: aluminum,
Impeller: bronze.

HIGH MOTOR PROPERTIES

- ✓ Power supply: 230 V, single phase, 50 Hz.
- ✓ Motor power: 1 - 2 HP.
- ✓ Asynchronous, 2 poles.
- ✓ Protection: IP 44 / Insulation: class F.
- ✓ Suitable for continuous service.
- ✓ Air-cooled.

NEW Diamond CPm 200



Pioneer in the pump,
with the assurance of Alarko Carrier...

Monoblock for Domestic use DIAMOND CPm200 CENTRIFUGAL PUMP

Gardens, sprinkler and irrigation works in touristic facilities, in the supply of clean water from wells, cisterns, and pressurized water systems...

Application Technique

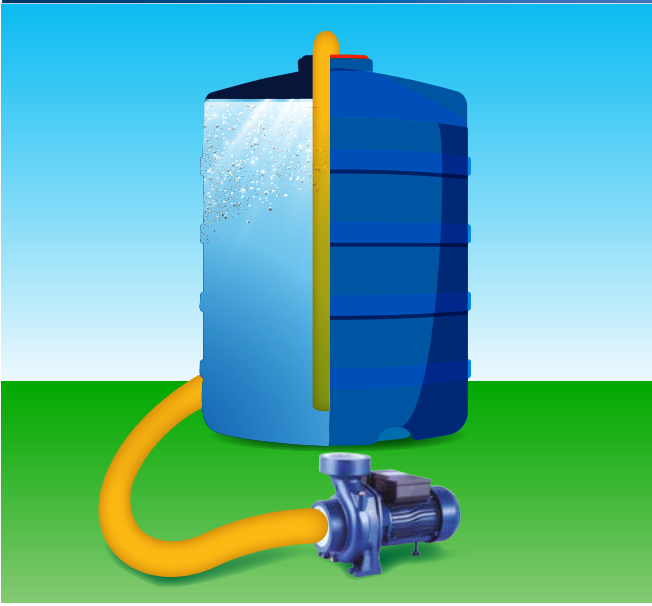

Pump Flow Rate (Q) - Head (H) Performance Data

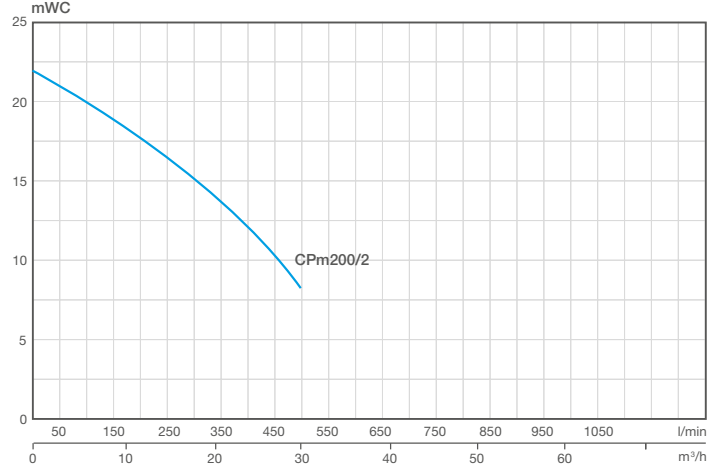

PARTS AND MATERIALS FOR CPm200 SERIES

Part	Material
Pump Body	AISI 304 SS
Diffuser	PPO
Impeller	PPO
Motor Casing	AISI 304 SS
Mechanical Seal	Graphite / Ceramic
Pump Shaft	AISI 304 SS ASTM 5140

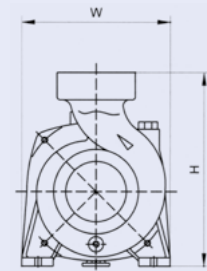
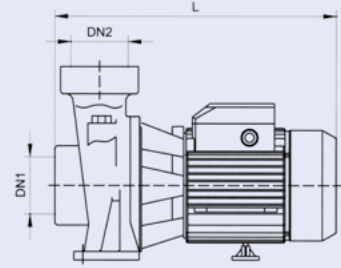

EB_AC_0112

PERFORMANCE DATA AND DIMENSIONS

ALARKO DIAMOND	Motor (HP)	Power kW	Total Height (H) mm	Total Length (L) mm	Total Weight (kg)	Pump Outlet Diameter (DN)	Capacity									
							m³/h	0	3	6	9	12	15	18	24	30
							l/min	0	50	100	150	200	250	300	400	500
CPm200/2	2	1.5	259	369	19	2"	Hm (mWC)	22	20.9	19.8	18.6	17.3	16	14.6	11.6	8

Note: Manufacturer reserves the right to change any product specifications without notice.

ALARKO



**ALARKO CARRIER
SANAYİ VE TİCARET A.Ş.**

GOSB - Gebze Organize Sanayi Bölgesi, Şahabettin Bilgisu Cad.

No:1604 Gebze 41480 KOCAELİ - TÜRKİYE

Phone: +90 262 648 60 00

Fax: +90262 648 60 08

www.alarko-carrier.com.tr

info@alarko-carrier.com.tr

D.2.101.110620/MNERAL