



# Submersible Pump Motors 6"-10"



SET WATER POWER FREE



SAB000  
BUREAU VERITAS  
Certification





Alarko submersible pumps are

**UNIQUE INDIVIDUAL  
and UNINTERRUPTED  
WATER SOURCE**

in potable water status by

- Evertime being ready to use,
- With no trouble
- And with short reimbursement term.



Alarko submersible pumps are

**MULTIFUNCTIONAL**

because of usable for from detached houses to skyscrapers and because of obtained advantage using it as a water stocking hydrophore.



Alarko submersible pumps are

**PROPER  
INVESTMENT**

in providing using water and process water in industrial facilities and administrations because of

- High efficiency
- And long life period.

# ALARKO, ALWAYS NUMBER ONE IN SUBMERSIBLE PUMPS







Alarko submersible pumps are

### **RELIABLE FRIENDS**

of garden lovers and farmers on horticulture, agriculture and from little house garden to agricultural land as thousands acres.



Alarko submersible pump is a

### **UNIQUE RELIABLE WATER**

SOURCE for touristic facilities, which especially need more water in tourism term.

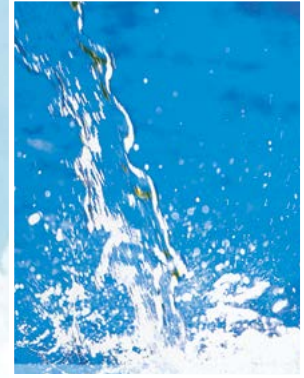

Alarko submersible pumps are

### **PREEMINENT**

because of

- High technology
- Economy
- Continual and quality service
- Quick procurement of spare part.





# ALARKO WATER COOLED SUBMERSIBLE PUMPS with REWINDABLE STATOR

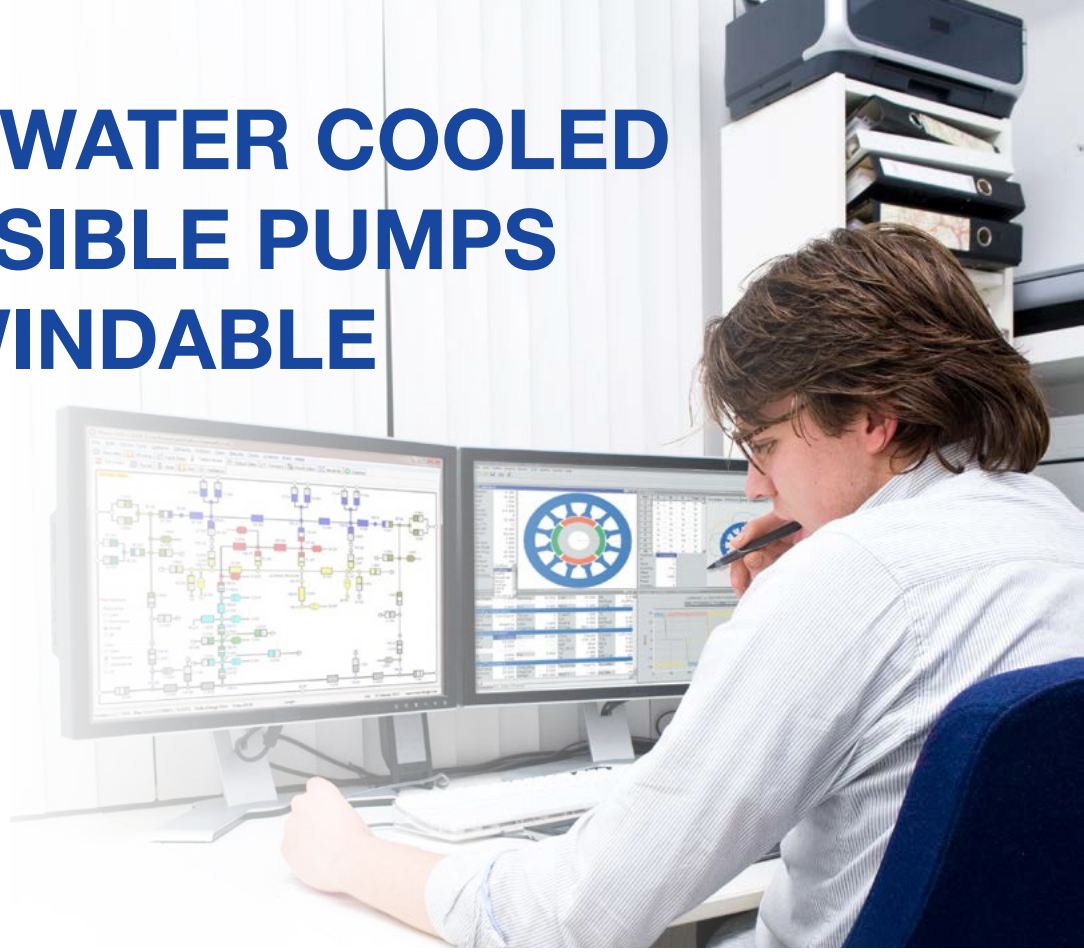

Thanks to modern simulation and state of the art engineering software, Alarko ALK motors are much more environmentally friendly with higher efficiency and CosineFi values. These motors not only contribute to the country's economy due to low energy consumption, but they also lead to lower carbon emissions.

**Materials used in these products are chosen not to affect and be affected by the environment in which they are being used. At the end of product service life, almost all of these materials are recycled due to high commercial value of scrap.**

Alarko Motors are individually tested in accordance with the applicable relevant standards in reliable and modern laboratories.

Extra safety is ensured in Alarko ALT Motors through thermal protection devices such as PCT / PT100.

## Standard features for Alarko Motors

- ✓ Pump connection compliant with NEMA Standards
- ✓ Rewindable stator
- ✓ Water lubricated and cooled axial bearings
- ✓ Coil wires resistant to high temperatures
- ✓ Waterproof motor outlet cable connection
- ✓ Special NBR membrane stabilizing motor internal pressure
- ✓ Special design preventing entrance of sand
- ✓ Motor outer diameter design compatible with drill pipe diameters
- ✓ Protective antifreeze application for keeping at low temperatures

## Optional features for Alarko Motors

- ✓ Special design for different voltage and frequency values
- ✓ Special models for 40°C well water
- ✓ IP 68 protection class
- ✓ Stainless steel motor body

APPLICATION LIMITS	ALARKO ALK MOTORS			
	ALK 6	ALK 7	ALK 8	ALK 10
Power (kW)	4-37	22-66	22-110	75-185
Power (HP)	5,5-50	30-90	30-150	100-250
Max. # of Start-ups per Hour	20	17	15 for 30-100 HP 10 for 110-125 HP	10
Startup Method	D -S/D		S/D	
Protection Class	IP 68			
PTC Outlet	Standard			
Supply Voltage (Volt)	380			
Frequency (Hz)	50			
Voltage Tolerance (%)	% 6 - % 10			
Ambient Temperature (°C)	30			
Min. Coolant Rate (cm/sec)	16			
Max. Amount of Sand in Water (gr/m³)	45			
Well Diameter	Pump Diameter + Minimum 2"/3"			



## MAIN PARTS and FEATURES

PART NO.	PART NAME	PROPERTIES
1	Upper Bearing Body	GG22
2	Bearing Bush	CARBON GRAPHITE
3	Rotor Spindle	X20Cr13
4	Spindle Bushing	St 37 (CrNi Coated)
5	Limitation Bearing	POLYAMIDE (NYLON 6.6)
6	Axial Bearing Upper Part	Chromium Coated Steel
7	Axial Carbon Bearing	STAINLESS STEEL
8	Tilting Pad	INOX
9	Thrust Bearing	Pig Cast - FG260
10	Lower Bearing Body	GG22
11	Membrane Body	GG22
12	Membrane Rubber	RUBBER SHR 80
13	Motor Casing	304 STAINLESS SHEET
14	Rubber Cover	RUBBER SHR 80
15	Coil Wire	PPC
16	Balance Ring	DRAWN STEEL PIPE ST44
17	Adjustment Screw	INOX

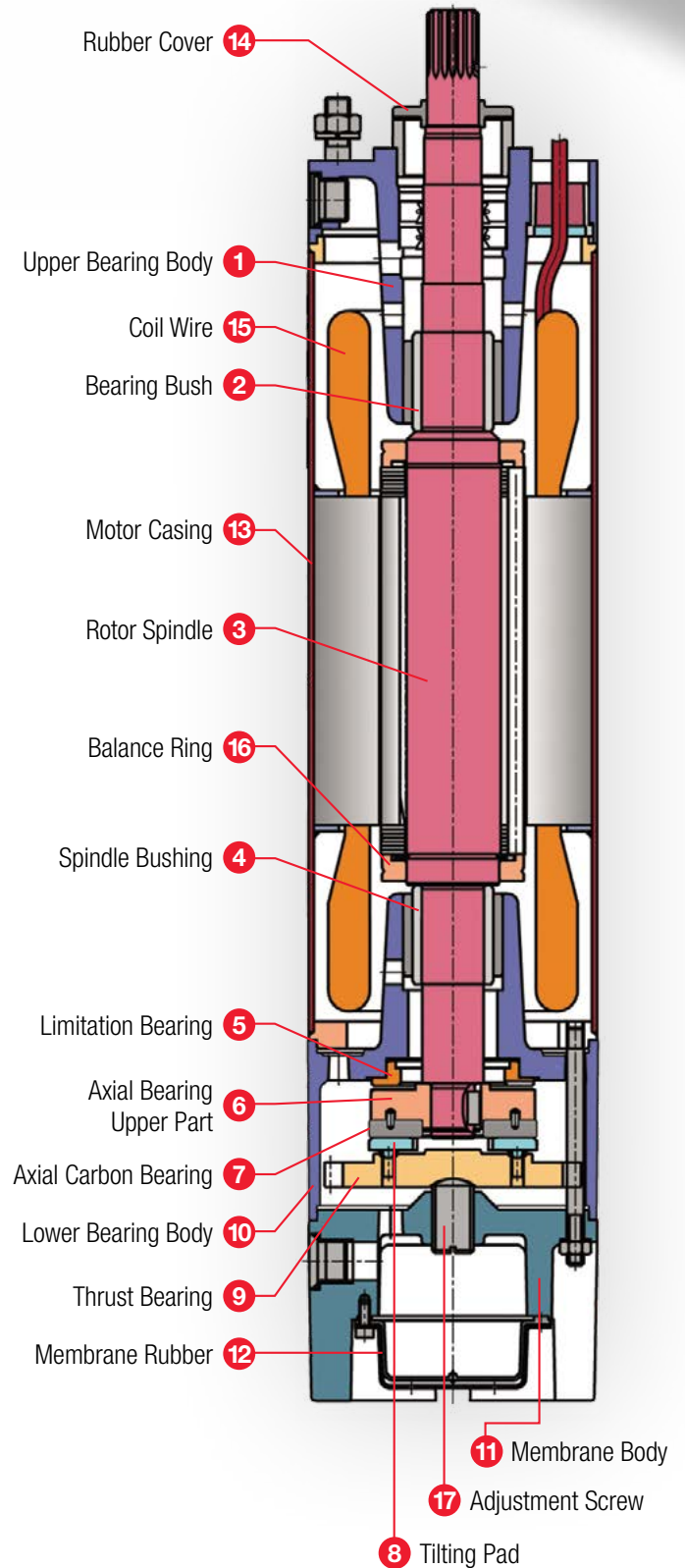

# ALK 6"

## SUBMERSIBLE PUMP MOTOR

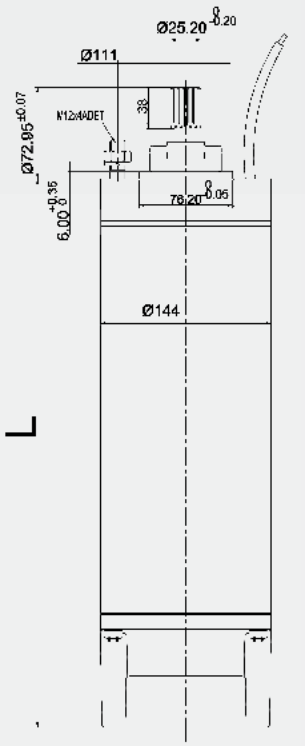

TECHNICAL SPECIFICATIONS													
MOTOR TYPE	Motor Power		Winding Method	Motor Efficiency	Power Factor	Rated Current	Startup	Rotation Speed	Weight	Axial Load	Motor Length L	Axial Gap	
	HP	kW	%	Cos Ø	In (A)	ls / In	rpm	kg	kN	mm	Min.	Max.	
ALK 6"	5.5	4	Y	77	0.83	10	6	2885	42	22	690	0.65	1.65
	7.5	5.5	Y	78	0.84	13	8	2880	46.2		735		
	10	7.5	Y	78	0.85	18	9	2870	51.2		780		
	12.5	9.2	Y	80	0.85	21	10	2860	54.6		810		
	15	11	Y	80	0.85	25	11	2845	56.8		840		
	17.5	13	Ü	81	0.85	31	19	2885	63	25	890		
	20	15	Ü	82	0.85	35	21	2875	67.2		930		
	25	18.5	Y/Ü	83	0.85	42	23	2880	76		1015		
	30	22	Y/Ü	81	0.84	51		2840	80.5	28	1060		
	35	26	Y/Ü	82	0.85	58	30	2815	91.6		1165		
	40	30	Y/Ü	83	0.84	66	36	2845	103		1275		
50	37	Y/Ü	81	0.85	81	0	2822	113	1365				

# ALK 7"

## SUBMERSIBLE PUMP MOTOR

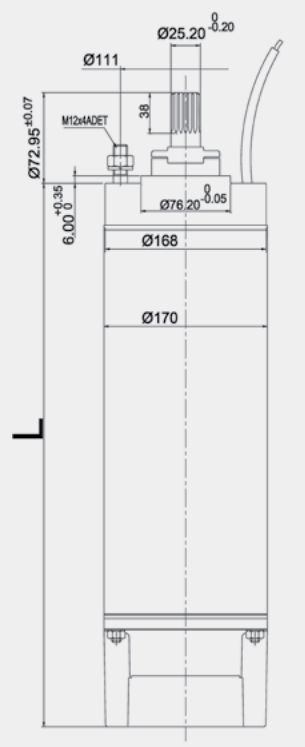

TECHNICAL SPECIFICATIONS													
MOTOR TYPE	Motor Power		Winding Method	Motor Efficiency	Power Factor	Rated Current	Startup	Rotation Speed	Weight	Axial Load	Motor Length L	Axial Gap	
	HP	kW	%	Cos Ø	In (A)	ls / In	rpm	kg	kN	mm	Min.	Max.	
ALK 7"	30	22	Y/Ü	84	0.85	48	4.5	2890	85	35	892	0.7	0.9
	40	30	Y/Ü	85	0.86	62		2875	85		972		
	50	37	Y/Ü	86	0.86	77		2875	111		1062		
	60	45	Y/Ü	86	0.86	91		2885	124		1142		
	70	51	Y/Ü	86	0.85	107		2890	139		1252		
	80	59	Y/Ü	88	0.86	119		2890	150		1328		
	90	66	Y/Ü	88	0.86	133		2890	167		1438		



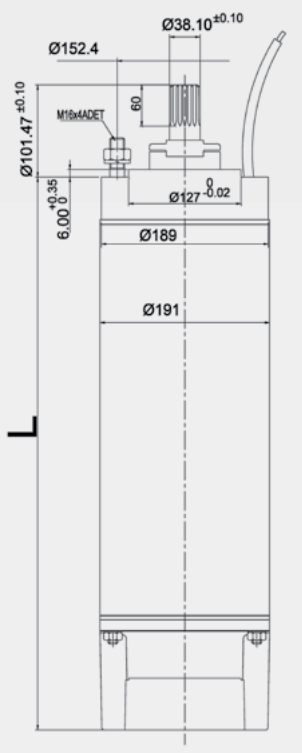

# ALK 8"

## SUBMERSIBLE PUMP MOTOR

TECHNICAL SPECIFICATIONS													
MOTOR TYPE	Motor Power		Winding Method	Motor Efficiency	Power Factor	Rated Current	Startup	Rotation Speed	Weight	Axial Load	Motor Length L	Axial Gap	
	HP	kW	%	Cos Ø	In (A)	ls / ln	rpm	kg	kN	mm	Min.	Max.	
ALK 8"	30	22	YÜ	82	0.85	50	4.5	2880	108	40	935	0.875	1.13
	40	30	YÜ	83	0.87	62		2880	125		1015		
	50	37	YÜ	85	0.87	76		2885	135		1065		
	60	45	YÜ	86	0.87	90		2885	144		1115		
	75	55	YÜ	86	0.87	112		2885	159		1195		
	80	59	YÜ	88	0.87	117		2870	161		1205		
	85	63	YÜ	87	0.87	126		2875	166		1235		
	90	66	YÜ	88	0.87	131		2885	179		1305		
	95	70	YÜ	87	0.87	141		2890	183		1335		
	100	75	YÜ	88	0.87	147		2890	194		1375		
	110	81	YÜ	88	0.87	161		2900	210	1465			
	125	92	YÜ	88	0.87	182		2900	230	1575			
	150	110	YÜ	87	0.87	220		2910	257	1725	45		

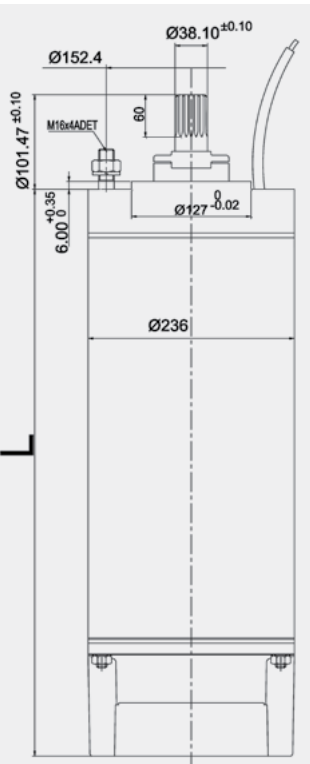

# ALK 10"

## SUBMERSIBLE PUMP MOTOR

TECHNICAL SPECIFICATIONS													
MOTOR TYPE	Motor Power		Winding Method	Motor Efficiency	Power Factor	Rated Current	Startup	Rotation Speed	Weight	Axial Load	Motor Length L	Axial Gap	
	HP	kW	%	Cos Ø	In (A)	ls / ln	rpm	kg	kN	mm	Min.	Max.	
ALK 10"	100	75	YÜ	86	0.87	150	4.5	2910	230	65	1224	1.3	1.7
	110	81	YÜ	86	0.87	166		2915	244		1264		
	125	92	YÜ	87	0.89	181		2910	258		1314		
	150	110	YÜ	87	0.89	220		2915	297		1444		
	175	129	YÜ	87	0.89	255		2920	325		1544		
	200	147	YÜ	88	0.89	290		2925	348		1664		
	225	165	YÜ	88	0.89	325		2930	390		1734		
	250	185	YÜ	88	0.9	355		2930	420		1834		



## ALARKO CARRIER GEBZE COMPLEX - ACGK



ACGK has a closed area of 36,800 m<sup>2</sup> on a 60,500 m<sup>2</sup> land in Gebze Organized Industrial Zone. Construction of the complex started on July 1, 1999 and completed on November 1, 2000.

Air handling unit and Roof-top is produced under Carrier brand at the ISO 9001, ISO 14001, ISO 50001, SA 8000, OHSAS 18000 certified Main Production Facility of the Alarko Carrier, which renovated its production technology and modernized its organization. Combi boilers, submersible pumps and circulation pumps are manufactured under Alarko brand in this facility as well.



Note: Manufacturer reserves the right to change any product specifications without notice.

**ALARKO**

Carrier

ALARKO CARRIER  
SANAYİ VE TİCARET A.Ş.

GOSB - Gebze Organize Sanayi Bölgesi, Şahabettin Bilgisu Cad.

No:1604 Gebze 41480 KOCAELİ - TÜRKİYE

Phone: +90 262 648 60 00

Fax: +90262 648 60 08

[www.alarko-carrier.com.tr](http://www.alarko-carrier.com.tr)

[info@alarko-carrier.com.tr](mailto:info@alarko-carrier.com.tr)